



49 Catspaw Avenue BEELIAR, WA

4 3 3

ANOTHER ONE BITES THE DUST!

Team KING are proud to present this great home sat on a 561sqm corner block in the award winning Meve Estate Beeliar.
With all these options it will literally suit every family there is.

Option 1, 4-Bed 3-Bath home with 2 large living areas

Option 2, 3-Bed 2-Bath home with a 1 bed 1 bath Granny Flat.

Option 3 is making up your own mind when you come take a look at this well presented home for yourself with freshly painted walls, new carpets and plenty of room for 3 cars in the garage and huge sheds.

VIEWING IS A MUST!!

Other Features include:

UNDER OFFER

Type : House
Sold Date : Tuesday, 19th November 2019
Land : 561 m2

Justine King

0452 554 647

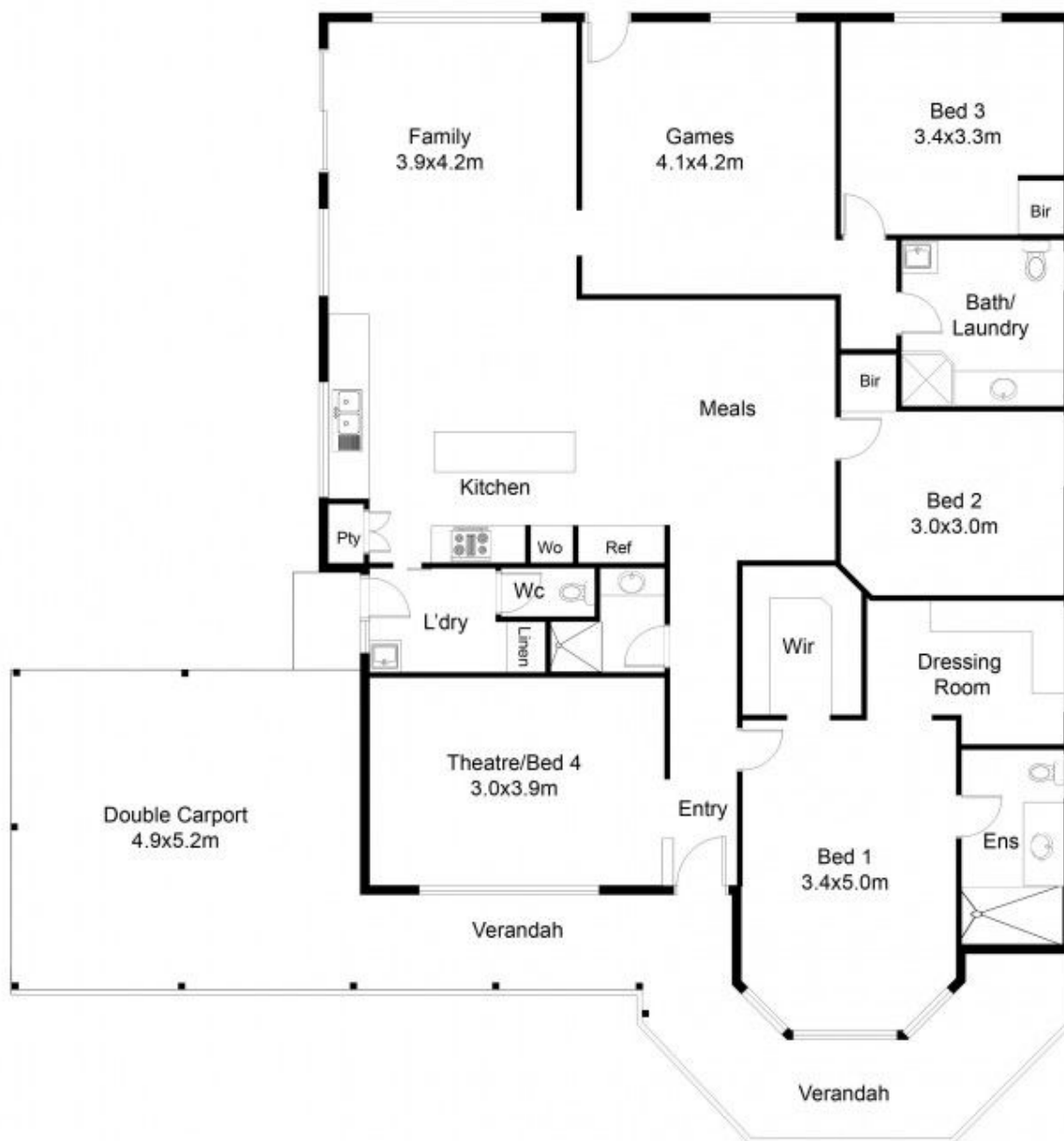

FLOOR PLAN

This floor plan including furniture, fixture measurements and dimensions are approximate and for illustrative purposes only.
 Boxbrownie.com gives no guarantee, warranty or representation as to the accuracy and layout.
 All enquiries must be directed to the agent, vendor or party representing this floor plan.

House	182.63m ²
Carport	28.63m ²
Verandah	19.01m ²
Total	230.40m²
Perimetre	56.78m ²

49 Catspaw Avenue, Beeliar