



13 Dolomite Road Treeby, WA

4 2 2

WOW, WHAT AN AUCTION!!

The auction will conclude Sunday 11th Feb 2024 at 4pm

Hurry this STUNNING HOME is attracting huge interest and truly is, 'a dream come true'!

An 'Aveling Homes' creation completed in 2019 with a massive 323sqm under the main roof and features galore!

SPECTACULAR best describes this family home with 31 course ceilings throughout, Fisher & Paykel appliances, 6.6kw of solar panels and a floor plan to satisfy everyone. The attention to detail is impressive, and with an OUTSTANDING kitchen that comes with a full BUTLERS pantry and SUPERB scullery.

Three separate living areas provide a lounge/theatre rm, family /meals PLUS a study/gaming room.

THIS WILL BE SOLD so hesitation may end in disappointment.

Type : House
Sold Date : Sunday, 11th February 2024
Land : 450 m2
Building Size : 238 m2

Water Rates : \$1,320.00/year (approx)

Brian Devereux

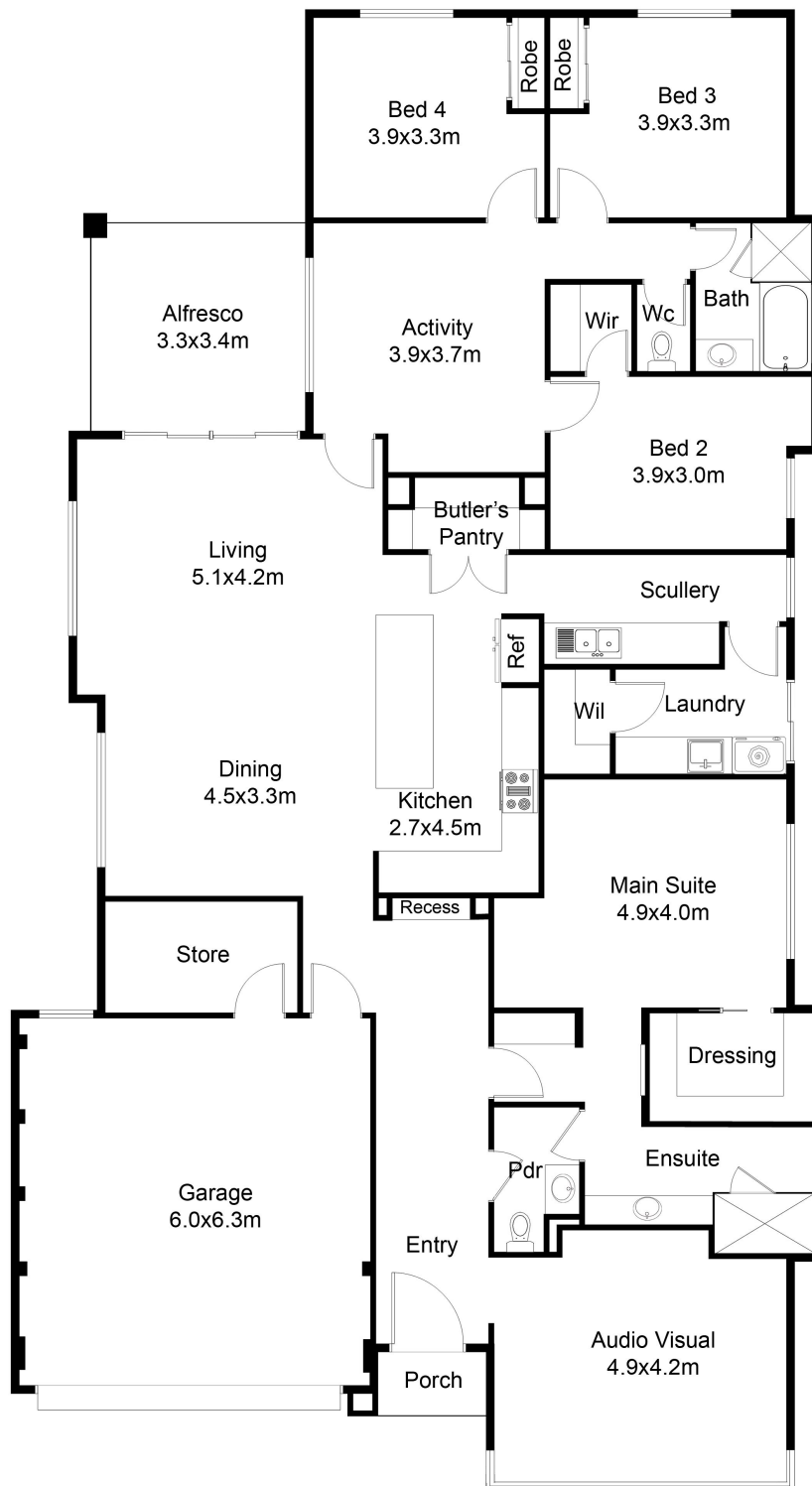

FLOOR PLAN

This floor plan including furniture, fixture measurements and dimensions are approximate and for illustrative purposes only.
 BoxBrownie.com gives no guarantee, warranty or representation as to the accuracy and layout.
 All enquiries must be directed to the agent, vendor or party representing this floor plan.

13 Dolomite Road Treeby